

Cleaved-MPO

Splice-On Connector

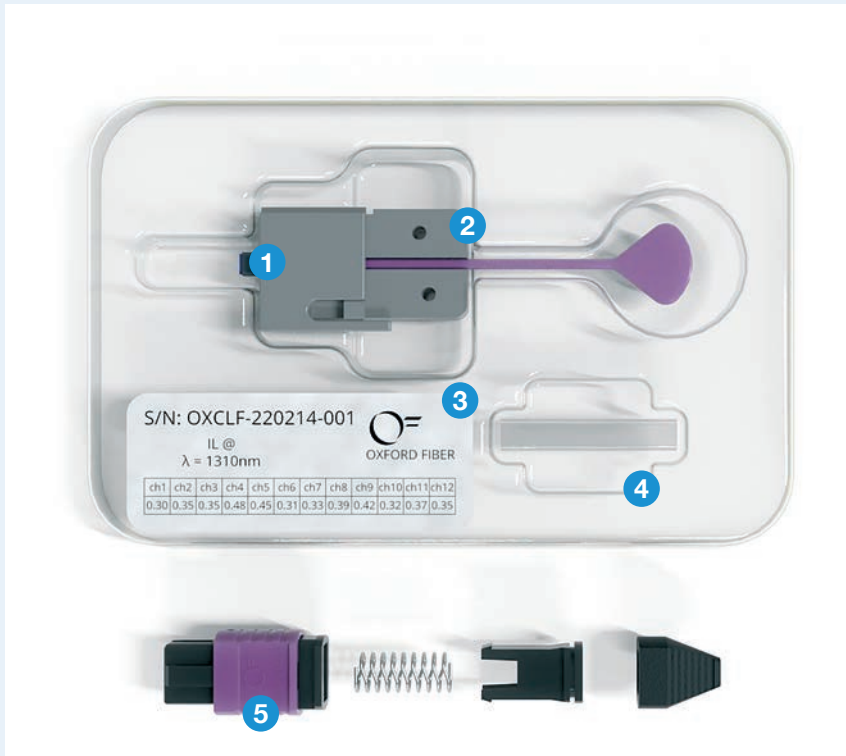

Cleaved-MPO ferrule connected to standard APC-MPO ferrule with air-gap

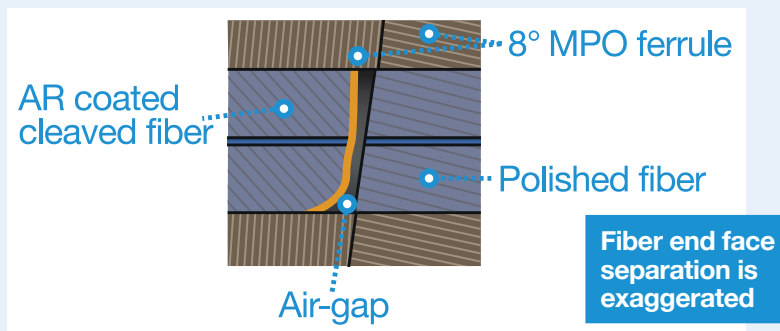

Oxford Fiber® offers the OXFORD Cleaved-MPO, the world's first rugged, cleaved MPO splice-on connector, allowing reliable field termination of ribbon fiber cables.

The Cleaved-MPO is designed to overcome the problem of dust contamination of MPO connections which leads to a failed connection. The Cleaved-MPO incorporates an air-gap between mating fibers and so is dust-insensitive. It can be mated/unmated over 100's of cycles with no change in performance. Excessive cleaning is no longer required giving longer lifetime and assured performance.

The pre-prepared ferrule comes in a sealed package ready for fusion splicing to external ribbon cables. The connector can be spliced by a range of fusion splicers using standard fiber tooling.

Key Features:

- Dust-insensitive MPO Connector
- Fusion splice-on
- Easy to clean
- > 100 mate/unmate cycles
- Insertion Loss < 0.5dB Average
- Return Loss < -55dB
- Can be mated with standard MPO or Cleaved-MPO connector
- Compatible with a range of fusion splicers
- Operating temperature of -40°C to +75°C

- 1 Pre-prepared ferrule with cleaved fiber stubs ready for fusion splicing
- 2 Holder
- 3 Insertion Loss Measurements
- 4 Splice Protection Sleeve
- 5 Housing Components



Oxford Fiber Ltd
Sir Frank Whittle Business Centre
Gt. Central Way, Butlers Leap
Rugby, CV21 3XH, UK

Tel: +44 (0) 1788 226 010
Website www.oxfordfiber.com
Email sales@oxfordfiber.com

Cleaved-MPO

Splice-On Connector

Applications

- Data Center Installation
- MDU FTTP Cabling
- Radio Access Networks
- Cable TV
- Harsh Environment
- Optical backplane interconnect

Connector Details

- **Splice-On connector type:** Cleaved-MPO: 12 channel SM fiber
- **Housing type:** 12-fiber bare ribbon
- Fusion splice protection sleeve
- Cleaved fiber ends in connector
- Cleave Angle: 8°
- Male or Female connectors; A-B polarity changeable
- AR coating 1250-1650nm

Specifications

Low Loss

Cleaved-MPO	Fiber Type	Value
IL*	Single Mode	< 0.5dB Average Max: 0.7dB
RL*	Single Mode	< -55dB

Standard Loss

Parameter	Fiber Type	Value
IL*	Single Mode	< 0.7dB Average Max: 1.0dB
RL*	Single Mode	< -55dB

*Connection to conventional APC-MPO, measured at 1310nm

Reliable Performance: Cleaved-MPO shows constant Insertion Loss over 100 cycles.

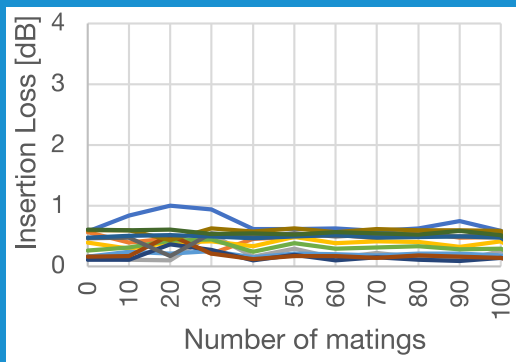

Cleaved-MPO

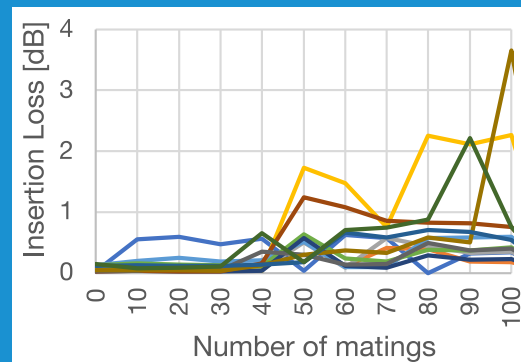

Conventional APC-MPO

Ordering Information

OXFORD-MPO12	Gender <u>A</u>	Endface Type <u>BB</u>	Fiber Type <u>CCCC</u>	Cable Media <u>DDDD</u>	Splicer Type <u>EE</u>	Pack Size <u>FF</u>
	Male <u>M</u>	Cleaved MPO <u>CL</u>	Single Mode Low Loss <u>SMLL</u>	Bare Ribbon <u>BR</u>	Sumitomo <u>FSUM</u>	#Connectors per pack <u>04</u>
	Female <u>F</u>		Single Mode Standard Loss <u>SMSL</u>			

OXFORD-Cleaved-MPO

Example: OXFORD-MPO12-F-CL-SMLL-BR-FSUM-04 = Rugged, 12-fiber splice-on, female, cleaved-MPO, single mode low-loss, spliced to bare ribbon with Sumitomo splicer. 4 connectors in pack



OXFORD FIBER®